

## 1. MANDREL CHANGE

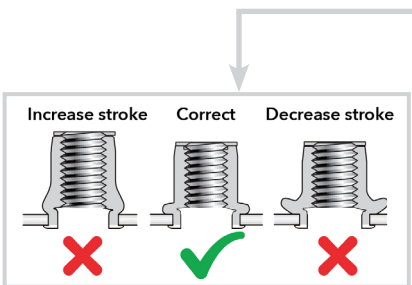

## 2. SETTING MODE

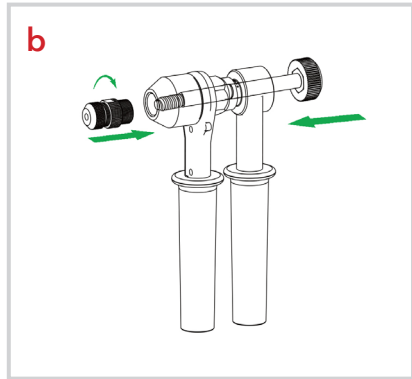
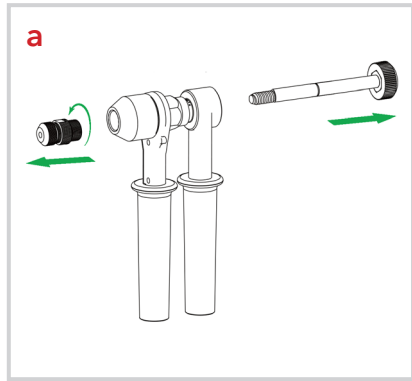
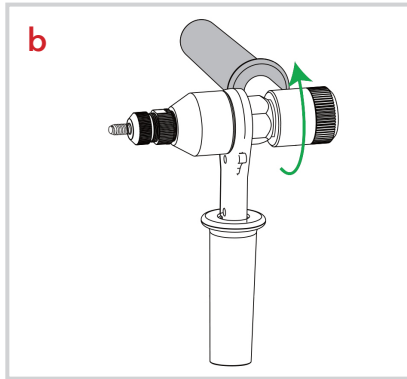
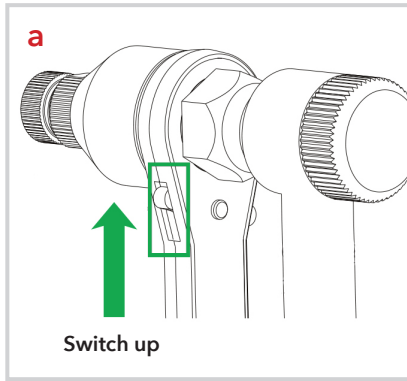

Rotate Rear Handle clockwise until the ratchet clicks

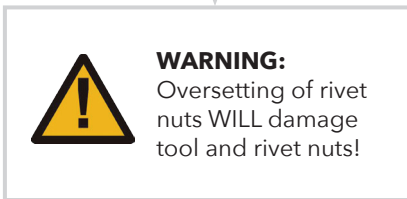

## 3. INSTALLATION

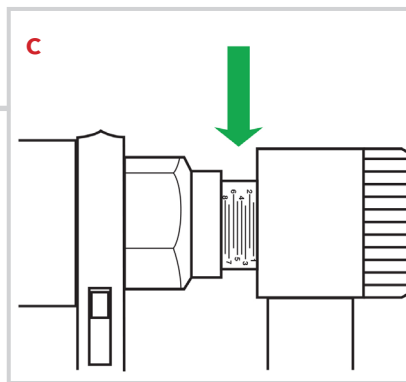
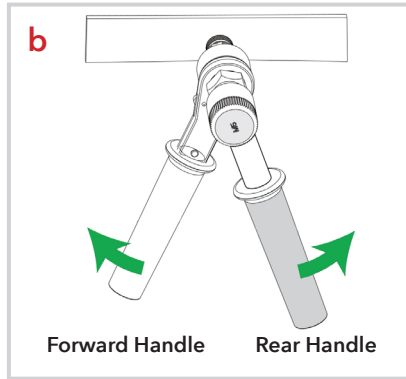
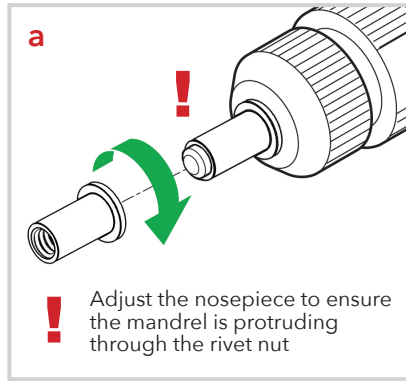

Take a note of the stroke for blind setting

## 4. TOOL RELEASE

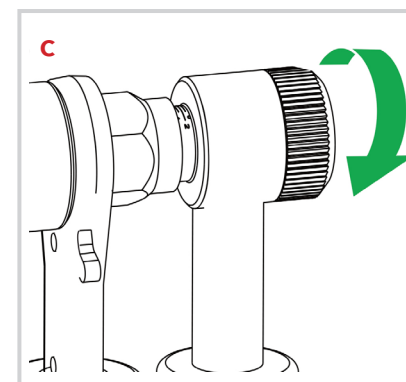
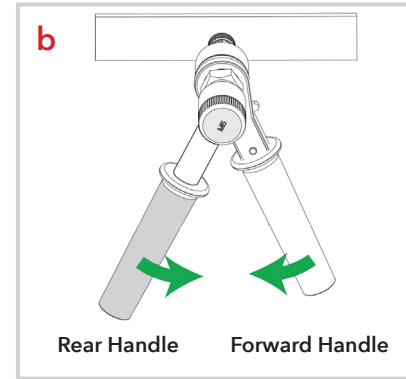
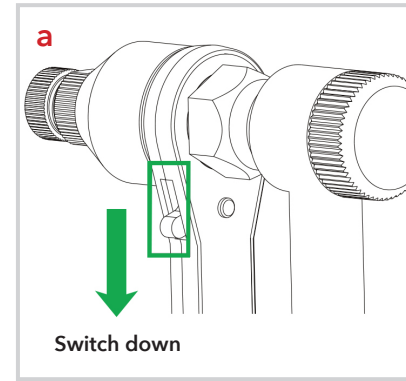

Repeat the process from Step 2

## SPARE PARTS

<p>Mandrel (included)</p>	M12	RS-00272
	M10	RS-00273
	M8	RS-00274
	M6	RS-00275
	M5	RS-00276
<p>Nosepiece (included)</p>	M12	RS-00377
	M10	RS-00378
	M8	RS-00306
	M6	RS-00307
	M5	RS-00308
<p>Rivstud Mandrel (included)</p>	M8	RS-00277
	M6	RS-00278
	M5	RS-00279
	1/2-13	RS-00281
	3/8-16	RS-00282
<p>Mandrel UNC (optional)</p>	5/16-18	RS-00283
	1/4-20	RS-00284
	10-24	RS-00285
	1/2-13	RS-03296
	3/8-16	RS-00378 *
<p>Nosepiece UNC (optional)</p>	5/16-18	RS-00306 *
	1/4-20	RS-03293
	10-24	RS-00308 *

\* Identical to the metric nosepiece

**Bolt & Nut Australia Pty Ltd**  
Unit 9 & 10, 93 Rivergate Place  
Murarrie QLD 4172  
Ph: 07 3192 9800  
Email: sales@boltandnut.com.au



Scan the QR code to view  
a demo video of the RT-512  
Ratchet Rivnut Tool

**BOLT & NUT**  
**AUSTRALIA**

PTY LTD.