

Disclaimer: Images are for illustrative purposes.

Socket Allen Screw

Head Style: Button Head

Drive Type: Internal Hex

Thread Type: Metric - Coarse

Material: Stainless Steel

Class Grade: A2-70 G304

Corrosion Protection Level: Excellent

Standard: ISO 7380

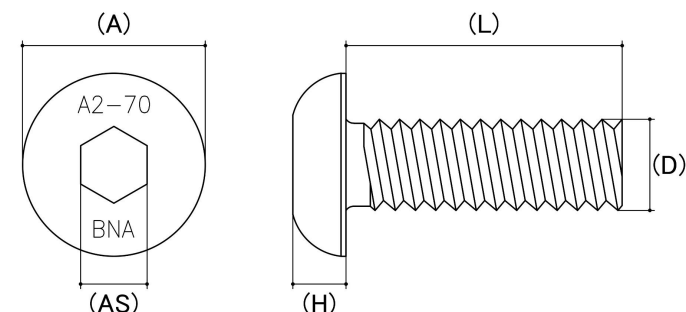

Size	Thread Pitch (mm)	Thread Type	Product Diameter (D) (mm)		Head Diameter (A) (mm)		Head Height (H) (mm)		Driver Bit Size (AS) (mm)	sku (Part Number)
			Min	Max	Min	Max	Min	Max		
M2	0.40mm	Coarse	1.88	1.98	3.20	3.50	1.10	1.30	1	31BS2
M2.5	0.45mm	Coarse	2.38	2.48	4.10	4.60	1.15	1.37	1	31BS25
M3	0.50mm	Coarse	2.87	2.98	5.40	5.70	1.40	1.65	2	31BS3
M4	0.70mm	Coarse	3.83	3.97	7.24	7.60	1.95	2.20	2	31BS4
M5	0.80mm	Coarse	4.82	5.00	9.14	9.50	2.50	2.75	3	31BS5
M6	1.00mm	Coarse	5.82	6.00	10.07	10.50	3.00	3.30	4	31BS6
M8	1.25mm	Coarse	7.78	8.00	13.57	14.00	4.10	4.40	5	31BS8
M10	1.50mm	Coarse	9.78	10.00	17.07	17.50	5.20	5.50	6	31BS10
M12	1.75mm	Coarse	11.73	12.00	20.48	21.00	6.24	6.60	8	31BS12
M16	2.00mm	Coarse	15.73	16.00	27.48	28.00	8.44	8.80	10	31BS16

Disclaimer:

Dimensional data and technical information was obtained from publicly available sources and not acquired through standard agencies. It has been completed and compiled for reference purposes only; where discrepancies are found they are subject to change without notice. Bolt & Nut Australia makes no warranties or representations regarding the accuracy and validity of the compiled information and data. Contact the relevant standard authorities for accurate and detailed information.

© Bolt & Nut Australia Pty Ltd. All rights reserved.

Version: 17 Mar 2026