

Disclaimer: Images are for illustrative purposes.

Socket Allen Screw

Head Style: Button Head

Drive Type: Internal Hex

Thread Type: Metric - Coarse

Material: Alloy Steel Heat Treated

Class Grade: High Tensile Class 12.9

Finish: Zinc Plated

Corrosion Protection Level: Moderate

Standard: ISO 7380

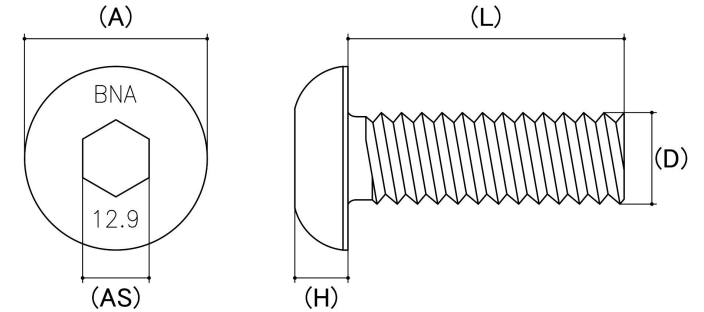

Size	Thread Pitch (mm)	Thread Type	Product Diameter (D) (mm)		Head Diameter (A) (mm)		Head Height (H) (mm)		Driver Bit Size (AS) (mm)	sku (Part Number)
			Min	Max	Min	Max	Min	Max		
M3	0.50mm	Coarse	2.87	2.98	5.40	5.70	1.40	1.65	2	31B3
M4	0.70mm	Coarse	3.83	3.97	7.24	7.60	1.95	2.20	2	31B4
M5	0.80mm	Coarse	4.82	5.00	9.14	9.50	2.50	2.75	3	31B5
M6	1.00mm	Coarse	5.82	6.00	10.07	10.50	3.00	3.30	4	31B6
M8	1.25mm	Coarse	7.78	8.00	13.57	14.00	4.05	4.40	5	31B8
M10	1.50mm	Coarse	9.78	10.00	17.07	17.50	5.20	5.50	6	31B10
M12	1.75mm	Coarse	11.73	12.00	20.48	21.00	6.24	6.60	8	31B12

Disclaimer:

Dimensional data and technical information was obtained from publicly available sources and not acquired through standard agencies. It has been completed and compiled for reference purposes only; where discrepancies are found they are subject to change without notice. Bolt & Nut Australia makes no warranties or representations regarding the accuracy and validity of the compiled information and data. Contact the relevant standard authorities for accurate and detailed information.

© Bolt & Nut Australia Pty Ltd. All rights reserved.

Version: 17 Mar 2026