

Disclaimer: Images are for illustrative purposes.

Cross Hole 90° Countersink Bit

System Of Measurement: Metric

Material: Cobalt High Speed Steel

Product Brand: Alpha

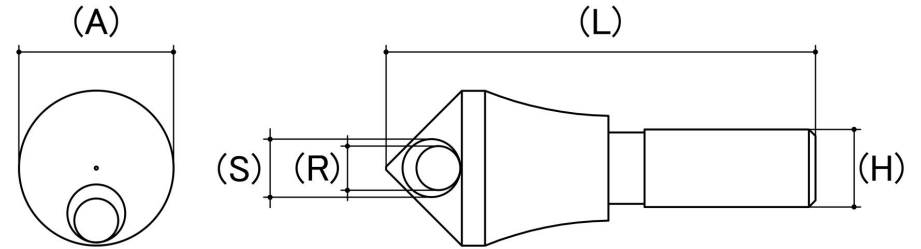

Size (S)	Drill Length (L) (mm)	Head Diameter (A) (mm)	Min To Max Drill Range (mm)		Countersink Angle	Shank (H) (mm)	Suitable For	sku (Part Number)
		Nom	Min	Max				
M10	46	10	4.00	9.00	90°	6	Steel, Wood, Plastic & Stainless Steel	12CS10CH
M14	46	14	6.00	13.00	90°	8	Steel, Wood, Plastic & Stainless Steel	12CS14CH
M21.5	64	21	8.00	19.00	90°	10	Steel, Wood, Plastic & Stainless Steel	12CS21.5CH
M28	80	28	10.00	24.00	90°	12	Steel, Wood, Plastic & Stainless Steel	12CS28CH
M35	97	35	12.00	32.00	90°	15	Steel, Wood, Plastic & Stainless Steel	12CS35CH
M44	115	44	16.00	40.00	90°	15	Steel, Wood, Plastic & Stainless Steel	12CS44CH

Disclaimer:

Dimensional data and technical information was obtained from publically available sources and not acquired through standard agencies. It has been completed and compiled for reference purposes only; where discrepancies are found they are subject to change without notice. Bolt & Nut Australia makes no warranties or representations regarding the accuracy and validity of the compiled information and data. Contact the relevant standard authorities for accurate and detailed information.

© Bolt & Nut Australia Pty Ltd. All rights reserved.

Version: 19 Mar 2026