

*Disclaimer: Images are for illustrative purposes.*

## Pad Eye Diamond

**Material:** Stainless Steel

**Class Grade:** A2-70 G304

**Corrosion Protection Level:** Excellent

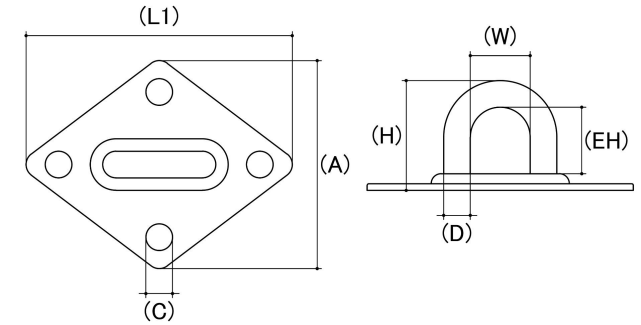

Size	Length L (1) (mm)	Height Overall (H) (mm)	Eye Diameter (D) (mm)	Inside Eye Width (W) (mm)	Height Of Eye (EH) (mm)	Holes Centre To Centre (S) (mm)	Width (A) (mm)	Hole Size (C) (mm)	sku (Part Number)
		Nom	Nom	Nom	Nom	Nom	Nom	Nom	
5mm	59.00	20.00	5.00	13.00	12.00	19.50	33.00	4.20	62PEDS537
6mm	64.00	26.00	6.00	17.00	17.00	23.00	40.00	4.20	62PEDS640
8mm	80.00	32.00	8.00	20.00	21.00	29.50	50.00	5.20	62PEDS850

**Disclaimer:**

Dimensional data and technical information was obtained from publicly available sources and not acquired through standard agencies. It has been completed and compiled for reference purposes only; where discrepancies are found they are subject to change without notice. Bolt & Nut Australia makes no warranties or representations regarding the accuracy and validity of the compiled information and data. Contact the relevant standard authorities for accurate and detailed information.

© Bolt & Nut Australia Pty Ltd. All rights reserved.

Version: 19 Mar 2026