

*Disclaimer: Images are for illustrative purposes.*

## Dowel Pin

**Material:** Hardened Alloy Steel

**Class Grade:** High Tensile

**Finish:** Plain Black Uncoated

**Corrosion Protection Level:** Low

**Standard:** DIN 6325

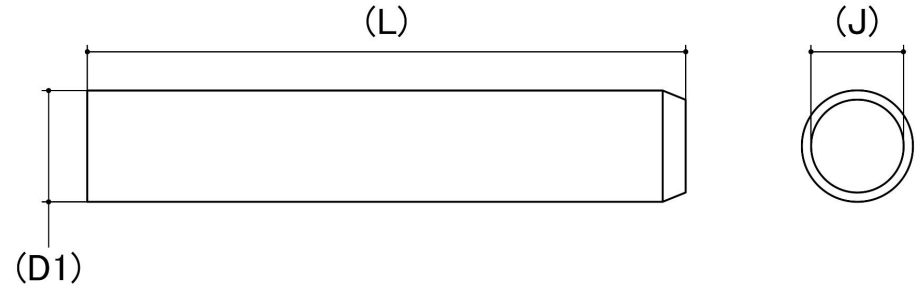

Size	Dowel Pin Diameter (D) (mm)		Point Diameter (J) (mm)		Crown Height (mm)		Double Shear Load (LB)	sku (Part Number)
	Min	Max	Min	Max	Min	Max		
1/16"	1.59	1.60	1.22	1.47	0.20	0.51	800.000	37DP116P
3/32"	2.38	2.39	2.01	2.26	0.30	0.79	1800.000	37DP332P
1/8"	3.17	3.18	2.79	3.05	0.41	1.04	3200.000	37DP18P
3/16"	4.76	4.77	4.32	4.57	0.58	1.57	7200.000	37DP316P
1/4"	6.35	6.36	5.84	6.10	0.79	2.11	12800.000	37DP14P
5/16"	7.94	7.95	7.37	7.67	0.99	2.64	20000.000	37DP516P
3/8"	9.52	9.53	8.89	9.27	1.19	3.18	28700.000	37DP38P
7/16"	11.11	11.12	10.39	10.77	1.40	3.71	39100.000	37DP716P
1/2"	12.70	12.71	11.96	12.34	1.60	4.24	51000.000	37DP112P
5/8"	15.87	12.88	15.11	15.52	1.98	5.28	79800.000	37DP58P

**Disclaimer:**

Dimensional data and technical information was obtained from publically available sources and not acquired through standard agencies. It has been completed and compiled for reference purposes only; where discrepancies are found they are subject to change without notice. Bolt & Nut Australia makes no warranties or representations regarding the accuracy and validity of the compiled information and data. Contact the relevant standard authorities for accurate and detailed information.

© Bolt & Nut Australia Pty Ltd. All rights reserved.

Version: 17 Mar 2026