

*Disclaimer: Images are for illustrative purposes.*

## Eye Bolt Nut Washer

**Material:** Stainless Steel

**Class Grade:** A2-70 G304

**Corrosion Protection Level:** Excellent

**Comments:** This product range is not rated and has no markings. Breaking load information provided is to be used as a guide only

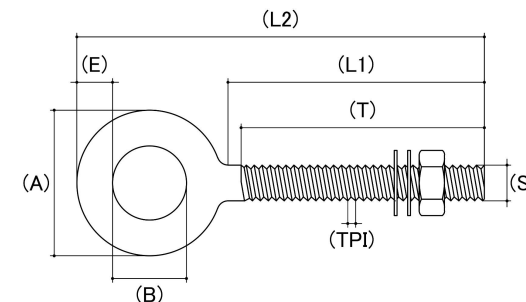

Size	Thread Pitch (mm)	Thread Type	Length L (1) (mm)	Length L (2) (mm)	Thread Length (T) (mm)		Inside dia. of Eye (B) (mm)		Width (A) (mm)	Thickness Of Eye (E) (mm)	Breaking Load Kgs (Not Rated Guide only)	sku (Part Number)
					Nom	Min	Max	Nom				
M5	0.80mm	Coarse	58.00	80.00	50.00	12.00	13.00	21.50	4.30	600	61EBS550	
M6	1.00mm	Coarse	40.00	64.00	35.00	13.00	14.00	32.00	6.00	1000	61EBS640	
M6	1.00mm	Coarse	60.00	104.00	55.00	13.00	14.00	32.00	6.00	1000	61EBS660	
M6	1.00mm	Coarse	80.00	104.00	75.00	13.00	14.00	32.00	6.00	1000	61EBS680	
M6	1.00mm	Coarse	100.00	124.00	95.00	13.00	14.00	32.00	6.00	1000	61EBS6100	
M8	1.25mm	Coarse	60.00	92.00	55.00	16.00	17.00	42.00	8.00	1800	61EBS860	
M8	1.25mm	Coarse	80.00	112.00	75.00	16.00	17.00	42.00	8.00	1800	61EBS880	
M8	1.25mm	Coarse	100.00	132.00	95.00	16.00	17.00	42.00	8.00	1800	61EBS8100	
M8	1.25mm	Coarse	130.00	162.00	125.00	16.00	17.00	42.00	8.00	1800	61EBS8130	
M10	1.50mm	Coarse	80.00	119.00	75.00	20.00	21.00	52.00	10.00	2400	61EBS1080	
M10	1.50mm	Coarse	100.00	139.00	95.00	20.00	21.00	52.00	10.00	2400	61EBS10100	
M10	1.50mm	Coarse	120.00	159.00	115.00	20.00	21.00	52.00	10.00	2400	61EBS10120	
M10	1.50mm	Coarse	150.00	189.00	145.00	20.00	21.00	52.00	10.00	2400	61EBS10150	
M12	1.75mm	Coarse	100.00	146.00	95.00	25.00	26.00	62.00	12.00	3500	61EBS12100	

Size	Thread Pitch (mm)	Thread Type	Length L (1) (mm)	Length L (2) (mm)	Thread Length (T) (mm)	Inside dia. of Eye (B) (mm)		Width (A) (mm)	Thickness Of Eye (E) (mm)	Breaking Load Kgs (Not Rated Guide only)	sku (Part Number)
					Nom	Min	Max	Nom	Nom	Nom	
M12	1.75mm	Coarse	150.00	196.00	145.00	25.00	26.00	62.00	12.00	3500	61EBS12150

**Disclaimer:**

Dimensional data and technical information was obtained from publically available sources and not acquired through standard agencies. It has been completed and compiled for reference purposes only; where discrepancies are found they are subject to change without notice. Bolt & Nut Australia makes no warranties or representations regarding the accuracy and validity of the compiled information and data. Contact the relevant standard authorities for accurate and detailed information.

© Bolt & Nut Australia Pty Ltd. All rights reserved.

Version: 19 Mar 2026