

*Disclaimer: Images are for illustrative purposes.*

## Flange Nyloc Insert Nut

**Thread Type:** Metric - Coarse

**Thread Direction:** Right Hand

**Material:** Stainless Steel

**Class Grade:** A2-70 G304

**Corrosion Protection Level:** Excellent

**Standard:** DIN 6926

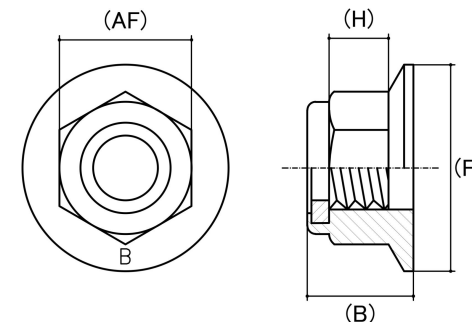

Size	Thread Pitch (mm)	Thread Type	Overall Nut Height (B) (mm)		Hex Height (H) (mm)	Flange Diameter (F) (mm)	Flange Thickness (D) (mm)	Across Flats (AF) (mm)		Spanner Size (AF) (mm)	sku (Part Number)
			Min	Max	Nom	Nom	Nom	Min	Max		
M3	0.50mm	Coarse	4.74	5.10	2.70	7.65	-	5.32	5.50	5.5mm	41FLNS3
M4	0.70mm	Coarse	5.74	6.10	3.00	10.10	-	6.78	7.00	7mm	41FLNS4
M5	0.80mm	Coarse	6.74	7.10	3.10	11.20	-	7.78	8.00	8mm	41FLNS5
M6	1.00mm	Coarse	8.74	9.10	3.10	14.20	2.00	9.78	10.00	10mm	41FLNS6
M8	1.25mm	Coarse	10.67	11.10	4.50	17.90	2.00	12.73	13.00	13mm	41FLNS8
M10	1.50mm	Coarse	13.30	13.60	5.50	21.80	2.26	14.73	15.00	15mm	41FLNS10
M12	1.75mm	Coarse	15.67	16.00	6.70	26.00	3.50	17.70	18.00	18mm	41FLNS12
M16	2.00mm	Coarse	19.46	20.00	9.00	34.50	4.50	23.67	24.00	24mm	41FLNS16

**Disclaimer:**

Dimensional data and technical information was obtained from publicly available sources and not acquired through standard agencies. It has been completed and compiled for reference purposes only; where discrepancies are found they are subject to change without notice. Bolt & Nut Australia makes no warranties or representations regarding the accuracy and validity of the compiled information and data. Contact the relevant standard authorities for accurate and detailed information.

© Bolt & Nut Australia Pty Ltd. All rights reserved.

Version: 17 Mar 2026