

Disclaimer: Images are for illustrative purposes.

Flange Nyloc Insert Nut

Thread Type: Metric - Coarse

Thread Direction: Right Hand

Material: Carbon Steel

Class Grade: High Tensile Class 8

Finish: Zinc Plated

Corrosion Protection Level: Moderate

Standard: DIN 6926

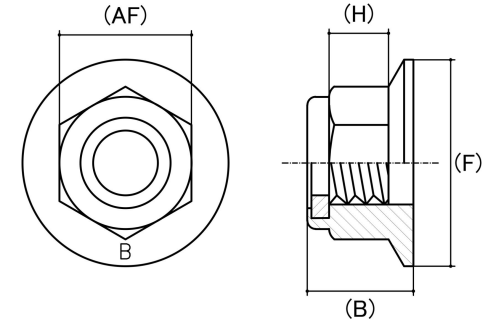

Size	Thread Pitch (mm)	Thread Type	Overall Nut Height (B) (mm)		Hex Height (H) (mm)	Flange Diameter (F) (mm)	Flange Thickness (D) (mm)	Across Flats (AF) (mm)		Spanner Size (AF) (mm)	sku (Part Number)
			Min	Max	Nom	Nom	Nom	Min	Max		
M6	1.00mm	Coarse	8.74	9.10	3.10	14.20	2.00	9.78	10.00	10mm	41FLN6
M8	1.25mm	Coarse	10.67	11.10	4.50	17.90	2.00	12.73	13.00	13mm	41FLN8
M10	1.50mm	Coarse	13.30	13.60	5.50	21.80	2.26	14.73	15.00	15mm	41FLN10
M12	1.75mm	Coarse	15.67	16.00	6.70	26.00	3.50	17.70	18.00	18mm	41FLN12

Disclaimer:

Dimensional data and technical information was obtained from publically available sources and not acquired through standard agencies. It has been completed and compiled for reference purposes only; where discrepancies are found they are subject to change without notice. Bolt & Nut Australia makes no warranties or representations regarding the accuracy and validity of the compiled information and data. Contact the relevant standard authorities for accurate and detailed information.

© Bolt & Nut Australia Pty Ltd. All rights reserved.

Version: 17 Mar 2026