

Disclaimer: Images are for illustrative purposes.

Flange Nyloc Insert Nut

Thread Type: UNC / BSW - Coarse

Thread Direction: Right Hand

Material: Carbon Steel

Class Grade: High Tensile Grade 5

Finish: Zinc Plated

Corrosion Protection Level: Moderate

Standard: DIN 6926

Comments: UNC and BSW have the same thread per inch (TPI) value, except for 1/2"

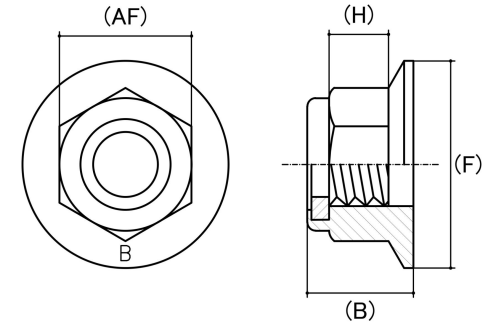

Size	Thread Pitch (TPI)	Thread Type	Overall Nut Height (B) (mm)		Hex Height (H) (mm)	Flange Diameter (F) (mm)	Flange Thickness (D) (mm)	Across Flats (AF) (mm)		Spanner Size (AF) (inches)	sku (Part Number)
			Min	Max	Nom	Nom	Nom	Min	Max		
1/4"	20 TPI	Coarse	6.90	7.15	3.59	14.00	1.66	10.88	11.16	7/16"	41FLNC14
5/16"	18 TPI	Coarse	8.85	9.10	4.32	17.00	2.15	12.43	12.76	1/2"	41FLNC516
3/8"	16 TPI	Coarse	10.30	10.60	5.85	20.00	2.65	14.00	14.28	9/16"	41FLNC38
7/16"	14 TPI	Coarse	12.15	12.40	5.85	23.40	3.00	17.15	17.48	11/16"	41FLNC716
1/2"	13 TPI	Coarse	13.60	13.90	6.40	26.80	3.75	18.70	19.05	3/4"	41FLNC12

Disclaimer:

Dimensional data and technical information was obtained from publically available sources and not acquired through standard agencies. It has been completed and compiled for reference purposes only; where discrepancies are found they are subject to change without notice. Bolt & Nut Australia makes no warranties or representations regarding the accuracy and validity of the compiled information and data. Contact the relevant standard authorities for accurate and detailed information.

© Bolt & Nut Australia Pty Ltd. All rights reserved.

Version: 17 Mar 2026