

*Disclaimer: Images are for illustrative purposes.*

## Standard Full Nut

**Thread Type:** BSW - Coarse

**Thread Direction:** Right Hand

**Material:** Stainless Steel

**Class Grade:** A2-70 G304

**Corrosion Protection Level:** Excellent

**Standard:** BS 1083

**Comments:** BSW and UNC have the same thread per inch (TPI) value, except for 1/2"

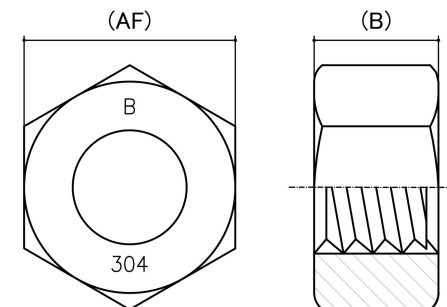

Size	Thread Pitch (TPI)	Thread Type	Overall Nut Height (B) (mm)		Across Flats (AF) (mm)		Spanner Size (AF) (inches)	sku (Part Number)
			Min	Max	Min	Max		
1/8"	40 TPI	Coarse	2.54	2.93	6.18	6.28	15/64"	41SW18
5/32"	32 TPI	Coarse	2.93	3.31	6.79	7.03	9/32"	41SW532
3/16" (#10-24)	24 TPI	Coarse	3.69	4.12	7.80	7.96	11/32"	41SW316
1/4"	20 TPI	Coarse	4.83	5.08	9.76	10.00	7/16"	41SW14
5/16"	18 TPI	Coarse	5.84	6.35	13.66	13.90	9/16"	41SW516
3/8"	16 TPI	Coarse	7.68	7.93	13.66	13.90	9/16"	41SW38
1/2"	12 TPI	Coarse	10.85	11.10	18.83	19.03	3/4"	41SW12
5/8"	11 TPI	Coarse	14.03	14.28	25.64	25.90	15/16"	41SW58
3/4"	10 TPI	Coarse	17.20	17.45	31.38	32.00	1-1/8"	41SW34
7/8"	9 TPI	Coarse	18.65	18.90	34.21	34.51	1-5/16"	41SW78

**Disclaimer:**

Dimensional data and technical information was obtained from publicly available sources and not acquired through standard agencies. It has been completed and compiled for reference purposes only; where discrepancies are found they are subject to change without notice. Bolt & Nut Australia makes no warranties or representations regarding the accuracy and validity of the compiled information and data. Contact the relevant standard authorities for accurate and detailed information.

© Bolt & Nut Australia Pty Ltd. All rights reserved.

Version: 17 Mar 2026