

Disclaimer: Images are for illustrative purposes.

Jaw Swage Rigging Screw

Material: Stainless Steel

Class Grade: A4-70 G316

Corrosion Protection Level: Ultimate

Comments: Use an anti-seize lubricant on the thread to reduce thread seizing. This product is not rated. Breaking loads information provided is to be used as a guide only.

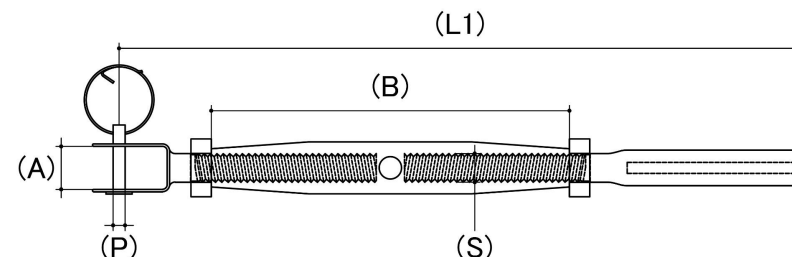

Size	Thread Pitch (mm)	Thread Type	Length L (1) (mm)	Wire Size (mm)	Body Length (mm)	Jaw Width (mm)	Pin Diameter (P) (mm)	Breaking Load Kgs (Not Rated Guide only)	sku (Part Number)
				Nom	Nom	Nom		Nom	
M5	0.80mm	Coarse	155.00	2.50	80.00	7.00	4.80	600	62RSSJS515525M
M5	0.80mm	Coarse	155.00	3.20	80.00	8.20	4.80	750	62RSSJS515532M
M6	1.00mm	Coarse	175.00	3.20	95.00	8.90	5.80	1000	62RSSJS617532M
M6	1.00mm	Coarse	190.00	4.00	95.00	9.50	5.80	1000	62RSSJS61754M
M8	1.25mm	Coarse	205.00	5.00	105.00	11.00	7.80	1100	62RSSJS82055M
M10	1.50mm	Coarse	240.00	5.00	125.00	12.50	8.90	2200	62RSSJS102305M
M10	1.50mm	Coarse	255.00	6.00	125.00	12.50	8.90	2200	62RSSJS102306M

Disclaimer:

Dimensional data and technical information was obtained from publicly available sources and not acquired through standard agencies. It has been completed and compiled for reference purposes only; where discrepancies are found they are subject to change without notice. Bolt & Nut Australia makes no warranties or representations regarding the accuracy and validity of the compiled information and data. Contact the relevant standard authorities for accurate and detailed information.

© Bolt & Nut Australia Pty Ltd. All rights reserved.

Version: 19 Mar 2026