

Disclaimer: Images are for illustrative purposes.

Metal Pin Anchor

Head Style: Mushroom Head

Body Type: All Metal

Material: Carbon Steel

Class Grade: Low Tensile Grade 2

Material Finish: Zinc Alloy

Corrosion Protection Level: Moderate

Internal External: Internal

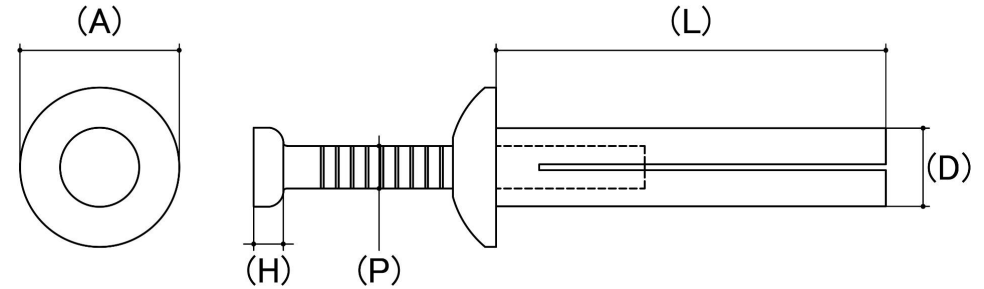

| Size | Length (L) (mm) | Embedment Depth (mm) | Min Material Thick (mm) | Max Fast Thickness (G) (mm) | Pin Diameter (P) (mm) | Drill Hole Size (mm) | sku (Part Number) |
|------|--------------------|-------------------------|----------------------------|--------------------------------|--------------------------|-------------------------|----------------------|
| M5 | 22 | 20 | 25 | 2 | 3 | 5 | 65MM522 |
| M6.5 | 25 | 20 | 25 | 5 | 4 | 6 | 65MM6525 |
| M6.5 | 32 | 25 | 35 | 7 | 4 | 6 | 65MM6532 |
| M6.5 | 38 | 30 | 40 | 8 | 4 | 6 | 65MM6538 |
| M6.5 | 50 | 35 | 45 | 15 | 4 | 6 | 65MM6550 |

Disclaimer:

Dimensional data and technical information was obtained from publically available sources and not acquired through standard agencies. It has been completed and compiled for reference purposes only; where discrepancies are found they are subject to change without notice. Bolt & Nut Australia makes no warranties or representations regarding the accuracy and validity of the compiled information and data. Contact the relevant standard authorities for accurate and detailed information.

© Bolt & Nut Australia Pty Ltd. All rights reserved.

Version: 17 Mar 2026