

*Disclaimer: Images are for illustrative purposes.*

## Nyloc Insert Nut

**Thread Type:** Metric - Coarse

**Thread Direction:** Right Hand

**Material:** Stainless Steel

**Class Grade:** A2-70 G304

**Corrosion Protection Level:** Excellent

**Standard:** DIN 985

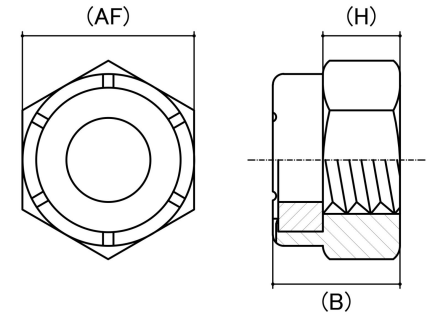

Size	Thread Pitch (mm)	Thread Type	Overall Nut Height (B) (mm)		Hex Height (H) (mm)	Across Flats (AF) (mm)		Spanner Size (AF) (mm)	sku (Part Number)
			Min	Max	Nom	Min	Max		
M2	0.40mm	Coarse	2.70	2.90	1.74	3.82	4.00	4mm	41NS2
M2.5	0.45mm	Coarse	3.30	3.60	2.00	4.82	5.00	5mm	41NS25
M3	0.50mm	Coarse	3.70	4.00	2.40	5.32	5.50	5.5mm	41NS3
M4	0.70mm	Coarse	4.70	5.00	3.20	6.78	7.00	7mm	41NS4
M5	0.80mm	Coarse	4.70	5.00	3.20	7.78	8.00	8mm	41NS5
M6	1.00mm	Coarse	5.70	6.00	4.00	9.78	10.00	10mm	41NS6
M8	1.25mm	Coarse	7.64	8.00	5.50	12.73	13.00	13mm	41NS8
M10	1.50mm	Coarse	9.64	10.00	6.50	16.73	17.00	17mm	41NS10
M12	1.75mm	Coarse	11.57	12.00	8.00	18.67	19.00	19mm	41NSM12
M14	2.00mm	Coarse	13.30	14.00	9.50	21.67	22.00	22mm	41NSM14
M16	2.00mm	Coarse	15.30	16.00	10.50	23.67	24.00	24mm	41NS16
M20	2.50mm	Coarse	18.67	20.00	14.00	29.16	30.00	30mm	41NS20
M24	3.00mm	Coarse	23.15	24.00	15.00	35.16	36.00	36mm	41NS24

**Disclaimer:**

Dimensional data and technical information was obtained from publically available sources and not acquired through standard agencies. It has been completed and compiled for reference purposes only; where discrepancies are found they are subject to change without notice. Bolt & Nut Australia makes no warranties or representations regarding the accuracy and validity of the compiled information and data. Contact the relevant standard authorities for accurate and detailed information.