

*Disclaimer: Images are for illustrative purposes.*

## Nyloc Insert Nut

**Thread Type:** Metric - Fine

**Thread Direction:** Right Hand

**Material:** Stainless Steel

**Class Grade:** A2-70 G304

**Corrosion Protection Level:** Excellent

**Standard:** DIN 985

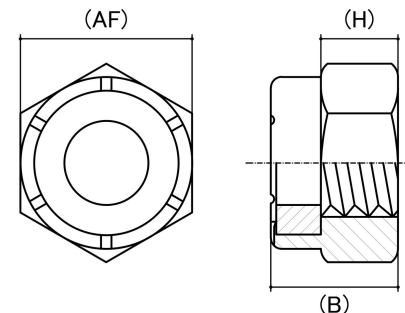

Size	Thread Pitch (mm)	Thread Type	Overall Nut Height (B) (mm)		Hex Height (H) (mm)	Across Flats (AF) (mm)		Spanner Size (AF) (mm)	sku (Part Number)
			Min	Max	Nom	Min	Max		
M8	1.00mm	Fine	7.64	8.00	5.50	12.73	13.00	13mm	41NMFS8100
M10	1.00mm	Fine	9.64	10.00	6.50	16.73	17.00	17mm	41NMFS10100
M12	1.50mm	Fine	11.57	12.00	8.00	18.67	19.00	19mm	41NMFS12150
M14	1.50mm	Fine	13.30	14.00	9.50	21.67	22.00	22mm	41NMFS14150
M16	1.50mm	Fine	15.30	16.00	9.50	23.67	24.00	24mm	41NMFS16150
M18	1.50mm	Fine	17.66	18.50	10.50	26.16	27.00	27mm	41NMFS18150
M20	1.50mm	Fine	18.67	20.00	14.00	29.16	30.00	30mm	41NMFS20150
M22	1.50mm	Fine	20.70	22.00	15.00	31.00	32.00	32mm	41NMFS22150
M24	2.00mm	Fine	23.15	24.00	15.00	35.16	36.00	36mm	41NMFS24200

**Disclaimer:**

Dimensional data and technical information was obtained from publically available sources and not acquired through standard agencies. It has been completed and compiled for reference purposes only; where discrepancies are found they are subject to change without notice. Bolt & Nut Australia makes no warranties or representations regarding the accuracy and validity of the compiled information and data. Contact the relevant standard authorities for accurate and detailed information.

© Bolt & Nut Australia Pty Ltd. All rights reserved.

Version: 17 Mar 2026