

Disclaimer: Images are for illustrative purposes.

Nyloc Insert Nut

Thread Type: Metric - Fine

Thread Direction: Right Hand

Material: Carbon Steel

Class Grade: High Tensile Class 8

Finish: Zinc Plated

Corrosion Protection Level: Moderate

Standard: DIN 985

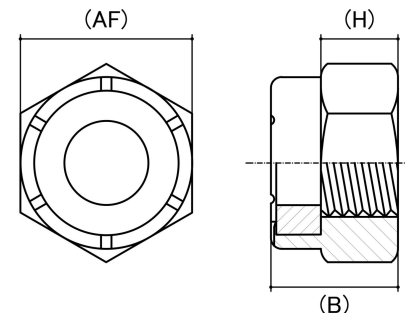

Size	Thread Pitch (mm)	Thread Type	Overall Nut Height (B) (mm)		Hex Height (H) (mm)	Across Flats (AF) (mm)		Spanner Size (AF) (mm)	sku (Part Number)
			Min	Max	Nom	Min	Max		
M8	1.00mm	Fine	7.64	8.00	5.50	12.73	13.00	13mm	41NMF8100
M10	1.00mm	Fine	9.64	10.00	6.50	16.73	17.00	17mm	41NMF10100
M10	1.25mm	Fine	9.64	10.00	6.50	16.73	17.00	17mm	41NMF10125
M12	1.25mm	Fine	11.57	12.00	8.00	18.67	19.00	19mm	41NMF12125
M12	1.50mm	Fine	11.57	12.00	8.00	18.67	19.00	19mm	41NMF12150
M14	1.50mm	Fine	13.30	14.00	9.50	21.67	22.00	22mm	41NMF14150
M16	1.50mm	Fine	15.30	16.00	10.50	23.67	24.00	24mm	41NMF16150
M18	1.50mm	Fine	17.66	18.50	13.00	26.16	27.00	27mm	41NMF18150
M20	1.50mm	Fine	18.67	20.00	14.00	29.16	30.00	30mm	41NMF20150
M22	1.50mm	Fine	20.70	22.00	15.00	31.00	32.00	32mm	41NMF22150
M24	2.00mm	Fine	23.15	24.00	15.00	35.16	36.00	36mm	41NMF24200
M30	1.50mm	Fine	28.70	30.00	19.00	45.00	46.00	46mm	41NMF30150
M30	2.00mm	Fine	28.70	30.00	19.00	45.00	46.00	46mm	41NMF30200
M36	3.00mm	Fine	34.40	36.00	25.00	53.80	55.00	55mm	41NMF36300

Disclaimer:

Dimensional data and technical information was obtained from publically available sources and not acquired through standard agencies. It has been completed and compiled for reference purposes only; where discrepancies are found they are subject to change without notice. Bolt & Nut Australia makes no warranties or representations regarding the accuracy and validity of the compiled information and data. Contact the relevant standard authorities for accurate and detailed information.