

Disclaimer: Images are for illustrative purposes.

Nyloc Insert Nut

Thread Type: UNC / BSW - Coarse

Thread Direction: Right Hand

Material: Stainless Steel

Class Grade: A4-70 G316

Corrosion Protection Level: Ultimate

Standard: NE Series

Comments: UNC and BSW have the same thread per inch (TPI) value, except for 1/2"

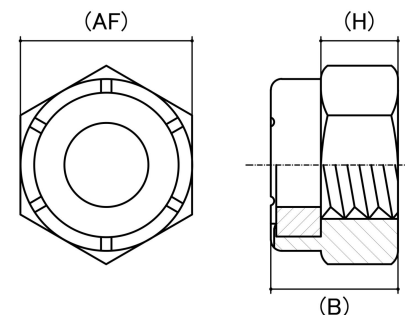

Size	Thread Pitch (TPI)	Thread Type	Overall Nut Height (B) (mm)		Hex Height (H) (mm)	Across Flats (AF) (mm)		Spanner Size (AF) (inches)	sku (Part Number)
			Min	Max	Nom	Min	Max		
#10-24 (3/16")	24 TPI	Coarse	5.80	6.30	3.70	9.20	9.53	3/8"	41NSC1024M
1/4"	20 TPI	Coarse	7.55	8.35	5.72	10.88	11.16	7/16"	41NSC14M
5/16"	18 TPI	Coarse	8.35	9.10	6.35	12.43	12.76	1/2"	41NSC516M
3/8"	16 TPI	Coarse	11.10	11.90	8.51	14.00	14.28	9/16"	41NSC38M
7/16"	14 TPI	Coarse	11.10	11.90	8.23	15.55	15.88	5/8"	41NSC716M
1/2"	13 TPI	Coarse	14.70	15.45	11.79	18.70	19.05	3/4"	41NSC12M
5/8"	11 TPI	Coarse	18.67	20.00	15.07	23.42	23.83	15/16"	41NSC58M
3/4"	10 TPI	Coarse	21.80	22.60	18.90	26.73	27.03	1-1/8"	41NSC34M
7/8"	9 TPI	Coarse	24.60	25.40	20.07	31.48	31.81	1-5/16"	41NSC78M
1"	8 TPI	Coarse	25.70	27.40	20.96	36.25	36.58	1-1/2"	41NSC1M
1-1/8"	7 TPI	Coarse	29.00	30.60	23.63	41.00	41.33	1-11/16"	41NSC118M
1-1/4"	7 TPI	Coarse	34.50	36.00	28.58	45.75	46.11	1-7/8"	41NSC114M

Disclaimer:

Dimensional data and technical information was obtained from publically available sources and not acquired through standard agencies. It has been completed and compiled for reference purposes only; where discrepancies are found they are subject to change without notice. Bolt & Nut Australia makes no warranties or representations regarding the accuracy and validity of the compiled information and data. Contact the relevant standard authorities for accurate and detailed information.

© Bolt & Nut Australia Pty Ltd. All rights reserved.

Version: 17 Mar 2026