

*Disclaimer: Images are for illustrative purposes.*

## Push Starlock Nut

**Material:** Hardened Carbon Steel

**Class Grade:** High Tensile

**Finish:** Black Oxide

**Corrosion Protection Level:** Low

**Comments:** Permanent assembly on unthreaded shafts

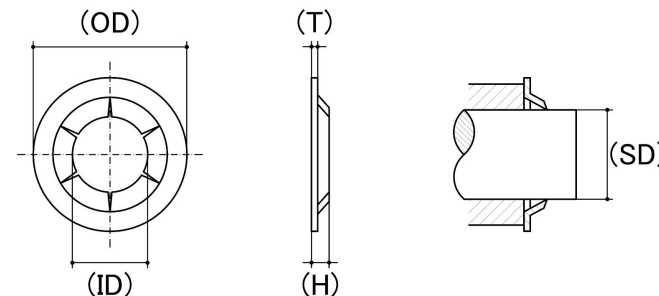

Size	Shaft Size (B) (mm)	Shaft Diameter (mm)	Inside Dia. (ID) (mm)	Outside Dimension (OD) (mm)	Thickness (T) (mm)	Unloaded Washer Height (H) (mm)	sku (Part Number)
	Nom	Nom	Nom	Nom	Nom	Nom	
M2	2.00	2.00	1.90	6.00	0.27	0.60	37PN2BO
M2.6	2.60	2.60	2.40	7.00	0.30	0.90	37PN2.6BO
M3	3.00	3.00	2.85	9.90	0.35	1.37	37PN3BO
M4	4.00	4.00	3.85	11.80	0.35	1.42	37PN4BO
M5	5.00	5.00	4.95	13.80	0.40	1.55	37PN5BO
M6	6.00	6.00	5.95	15.80	0.40	1.80	37PN6BO
M8	8.00	8.00	7.95	17.50	0.50	1.80	37PN8BO
M10	10.00	10.00	9.95	20.80	0.70	2.25	37PN10BO
M12	12.00	12.00	11.95	27.00	0.87	2.85	37PNM12BO
M16	16.00	16.00	15.75	30.00	0.90	2.45	37PN16BO

**Disclaimer:**

Dimensional data and technical information was obtained from publicly available sources and not acquired through standard agencies. It has been completed and compiled for reference purposes only; where discrepancies are found they are subject to change without notice. Bolt & Nut Australia makes no warranties or representations regarding the accuracy and validity of the compiled information and data. Contact the relevant standard authorities for accurate and detailed information.

© Bolt & Nut Australia Pty Ltd. All rights reserved.

Version: 17 Mar 2026