

*Disclaimer: Images are for illustrative purposes.*

## Saddle Eye Strap

**Material:** Stainless Steel

**Class Grade:** A2-70 G304

**Corrosion Protection Level:** Excellent

**Comments:** This product range is not rated and has no markings. Breaking load information provided is to be used as a guide only

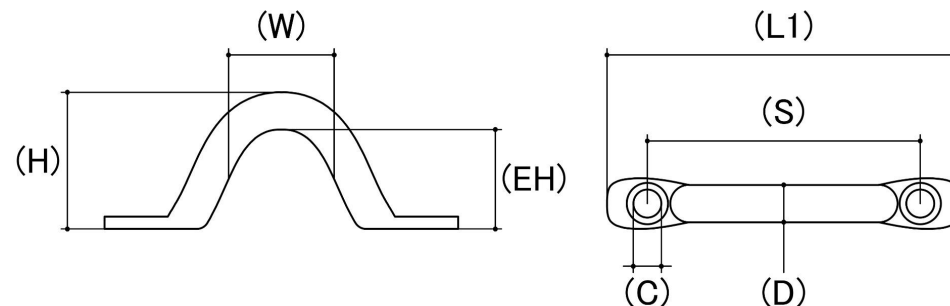

Size	Length L (1) (mm)	Height Overall (H) (mm)	Height Of Eye (EH) (mm)	Holes Centre To Centre (S) (mm)	Saddle Inside Width (W) (mm)	Hole Size (C) (mm)	sku (Part Number)
		Nom	Nom	Nom	Nom	Nom	
4mm	40.00	16.00	11.00	32.00	10.00	3.20	62SES440
5mm	51.00	16.00	13.00	40.00	11.00	4.00	62SES551
6mm	57.00	22.00	16.00	44.00	14.00	5.20	62SES657
8mm	63.00	25.00	17.00	47.00	11.00	5.20	62SES863

**Disclaimer:**

Dimensional data and technical information was obtained from publically available sources and not acquired through standard agencies. It has been completed and compiled for reference purposes only; where discrepancies are found they are subject to change without notice. Bolt & Nut Australia makes no warranties or representations regarding the accuracy and validity of the compiled information and data. Contact the relevant standard authorities for accurate and detailed information.

© Bolt & Nut Australia Pty Ltd. All rights reserved.

Version: 19 Mar 2026