

Disclaimer: Images are for illustrative purposes.

Square U Bolt Nut Flat Washer Kit

Thread Type: BSW - Coarse

Material: Mild Steel

Class Grade: Low Tensile Grade 2

Finish: Galvanised

Corrosion Protection Level: Excellent

Standard: Made to Hobson Engineering Standard

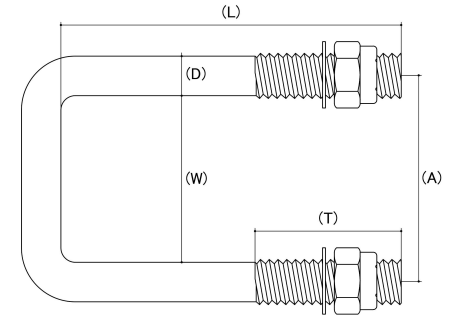

Size	Thread Pitch (TPI)	Thread Type	Product Diameter (D) (mm)		Inside Width (W) (mm)		Centre Width (A) (mm)		Overall length Inside (L) (mm)		Thread Length Per Leg (T) (mm)		sku (Part Number)
			Min	Max	Min	Max	Min	Max	Min	Max	Min	Max	
1/2"	12 TPI	Coarse	12.53	12.70	39.00	41.00	52.00	54.00	99.00	101.00	59.00	61.00	58USW1240100G
1/2"	12 TPI	Coarse	12.53	12.70	39.00	41.00	52.00	54.00	111.00	113.00	59.00	61.00	58USW1240112G
1/2"	12 TPI	Coarse	12.53	12.70	39.00	41.00	52.00	54.00	124.00	126.00	59.00	61.00	58USW1240125G
1/2"	12 TPI	Coarse	12.53	12.70	39.00	41.00	52.00	54.00	136.00	138.00	59.00	61.00	58USW1240137G
1/2"	12 TPI	Coarse	12.53	12.70	39.00	41.00	52.00	54.00	149.00	151.00	59.00	61.00	58USW1240150G
1/2"	12 TPI	Coarse	12.53	12.70	44.00	46.00	57.00	59.00	99.00	101.00	59.00	61.00	58USW1245100G
1/2"	12 TPI	Coarse	12.53	12.70	44.00	46.00	57.00	59.00	111.00	113.00	59.00	61.00	58USW1245112G
1/2"	12 TPI	Coarse	12.53	12.70	44.00	46.00	57.00	59.00	124.00	126.00	59.00	61.00	58USW1245125G
1/2"	12 TPI	Coarse	12.53	12.70	44.00	46.00	57.00	59.00	136.00	138.00	59.00	61.00	58USW1245137G
1/2"	12 TPI	Coarse	12.53	12.70	44.00	46.00	57.00	59.00	149.00	151.00	59.00	61.00	58USW1245150G
1/2"	12 TPI	Coarse	12.53	12.70	44.00	46.00	57.00	59.00	161.00	163.00	59.00	61.00	58USW1245162G
1/2"	12 TPI	Coarse	12.53	12.70	44.00	46.00	57.00	59.00	174.00	176.00	59.00	61.00	58USW1245175G
1/2"	12 TPI	Coarse	12.53	12.70	49.00	51.00	62.00	64.00	74.00	76.00	49.00	51.00	58USW125075G
1/2"	12 TPI	Coarse	12.53	12.70	49.00	51.00	62.00	64.00	99.00	101.00	59.00	61.00	58USW1250100G
1/2"	12 TPI	Coarse	12.53	12.70	49.00	51.00	62.00	64.00	111.00	113.00	59.00	61.00	58USW1250112G

Size	Thread Pitch (TPI)	Thread Type	Product Diameter (D) (mm)		Inside Width (W) (mm)		Centre Width (A) (mm)		Overall length Inside (L) (mm)		Thread Length Per Leg (T) (mm)		sku (Part Number)
			Min	Max	Min	Max	Min	Max	Min	Max	Min	Max	
1/2"	12 TPI	Coarse	12.53	12.70	49.00	51.00	62.00	64.00	124.00	126.00	59.00	61.00	58USW1250125G
1/2"	12 TPI	Coarse	12.53	12.70	49.00	51.00	62.00	64.00	136.00	138.00	59.00	61.00	58USW1250137G
1/2"	12 TPI	Coarse	12.53	12.70	49.00	51.00	62.00	64.00	149.00	151.00	59.00	61.00	58USW1250150G
1/2"	12 TPI	Coarse	12.53	12.70	49.00	51.00	62.00	64.00	161.00	163.00	59.00	61.00	58USW1250162G
1/2"	12 TPI	Coarse	12.53	12.70	49.00	51.00	62.00	64.00	174.00	176.00	59.00	61.00	58USW1250175G
1/2"	12 TPI	Coarse	12.53	12.70	49.00	51.00	62.00	64.00	199.00	201.00	59.00	61.00	58USW1250200G
1/2"	12 TPI	Coarse	12.53	12.70	49.00	51.00	62.00	64.00	249.00	251.00	59.00	61.00	58USW1250250G
1/2"	12 TPI	Coarse	12.53	12.70	55.00	57.00	68.00	70.00	111.00	113.00	59.00	61.00	58USW1256112G
1/2"	12 TPI	Coarse	12.53	12.70	55.00	57.00	68.00	70.00	124.00	126.00	59.00	61.00	58USW1256125G
1/2"	12 TPI	Coarse	12.53	12.70	55.00	57.00	68.00	70.00	136.00	138.00	59.00	61.00	58USW1256137G
1/2"	12 TPI	Coarse	12.53	12.70	55.00	57.00	68.00	70.00	161.00	163.00	59.00	61.00	58USW1256162G
1/2"	12 TPI	Coarse	12.53	12.70	74.00	76.00	87.00	89.00	74.00	76.00	49.00	51.00	58USW127575G
1/2"	12 TPI	Coarse	12.53	12.70	74.00	76.00	87.00	89.00	99.00	101.00	49.00	51.00	58USW1275100G
1/2"	12 TPI	Coarse	12.53	12.70	74.00	76.00	87.00	89.00	124.00	126.00	59.00	61.00	58USW1275125G
1/2"	12 TPI	Coarse	12.53	12.70	74.00	76.00	87.00	89.00	149.00	151.00	59.00	61.00	58USW1275150G
1/2"	12 TPI	Coarse	12.53	12.70	99.00	101.00	112.00	114.00	74.00	76.00	39.00	41.00	58USW1210075G
1/2"	12 TPI	Coarse	12.53	12.70	99.00	101.00	112.00	114.00	99.00	101.00	59.00	61.00	58USW12100100G
1/2"	12 TPI	Coarse	12.53	12.70	99.00	101.00	112.00	114.00	124.00	126.00	59.00	61.00	58USW12100125G

Disclaimer:

Dimensional data and technical information was obtained from publicly available sources and not acquired through standard agencies. It has been completed and compiled for reference purposes only; where discrepancies are found they are subject to change without notice. Bolt & Nut Australia makes no warranties or representations regarding the accuracy and validity of the compiled information and data. Contact the relevant standard authorities for accurate and detailed information.

© Bolt & Nut Australia Pty Ltd. All rights reserved.

Version: 17 Mar 2026