

Disclaimer: Images are for illustrative purposes.

Suspension Anchor

Head Style: Tie Wire

Material: Carbon Steel

Class Grade: Low Tensile Class 5.8

Material Finish: Zinc Yellow Plated

Corrosion Protection Level: Moderate

Internal External: Internal

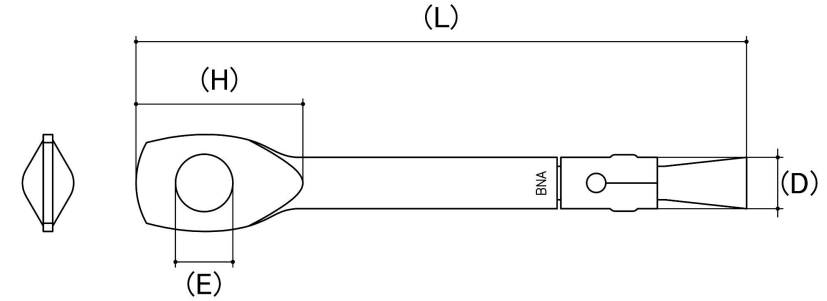

Size	Length (L) (mm)	Head Height (H) (mm)	Eyelet Diameter (E) (mm)	Embedment Depth (mm)	Minimum Spacing (mm)	Drill Hole Depth (mm)	Drill Hole Size (mm)	sku (Part Number)
M6	60	14.00	6	30	90	45	6	65TWSA660

Disclaimer:

Dimensional data and technical information was obtained from publically available sources and not acquired through standard agencies. It has been completed and compiled for reference purposes only; where discrepancies are found they are subject to change without notice. Bolt & Nut Australia makes no warranties or representations regarding the accuracy and validity of the compiled information and data. Contact the relevant standard authorities for accurate and detailed information.

© Bolt & Nut Australia Pty Ltd. All rights reserved.

Version: 17 Mar 2026

BOLT & NUT AUSTRALIA