

*Disclaimer: Images are for illustrative purposes.*

## Wing Nut

**Thread Type:** Metric - Coarse

**Thread Direction:** Right Hand

**Material:** Carbon Steel

**Class Grade:** Low Tensile Class 4.6

**Finish:** Zinc Plated

**Corrosion Protection Level:** Moderate

**Standard:** UNI 5448

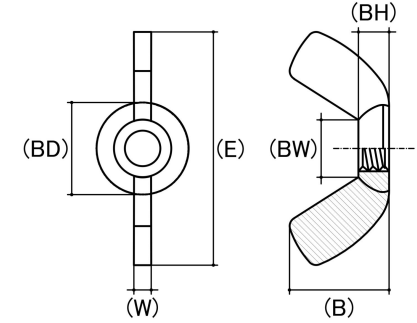

Size	Thread Pitch (mm)	Thread Type	Overall Nut Height (B) (mm)		Boss Diameter (BD) (mm)		Wing Span Range (E) (mm)		Wing Thickness (W) (mm)		Boss Height (BH) (mm)		Between Wings (BW) (mm)		sku (Part Number)
			Min	Max	Min	Max	Min	Max	Min	Max	Min	Max	Min	Max	
M3	0.50mm	Coarse	8.00	9.10	7.00	8.00	17.25	19.50	2.10	2.80	2.85	3.30	5.10	6.25	41W3
M4	0.70mm	Coarse	8.00	9.10	7.20	7.80	18.00	19.00	2.20	2.40	3.00	3.20	5.20	5.50	41W4
M5	0.80mm	Coarse	9.60	11.00	9.90	10.90	19.00	24.00	2.50	3.56	3.80	4.00	6.10	6.30	41W5
M6	1.00mm	Coarse	11.00	13.50	11.40	12.70	24.00	28.00	3.50	4.50	4.70	5.00	8.00	8.60	41W6
M8	1.25mm	Coarse	13.60	15.50	12.90	14.70	26.00	32.00	4.30	5.38	5.10	5.70	8.00	8.60	41W8
M10	1.50mm	Coarse	16.50	18.50	16.20	17.70	33.00	37.00	5.00	6.10	5.70	6.30	10.30	10.60	41W10
M12	1.75mm	Coarse	21.00	25.40	21.80	23.65	45.00	50.00	6.60	8.40	7.60	8.40	13.10	13.50	41WM12
M16	2.00mm	Coarse	28.00	30.80	23.00	26.00	58.00	65.00	6.50	8.30	10.50	10.80	18.00	19.00	41W16
M20	2.50mm	Coarse	31.00	35.00	27.50	30.50	64.00	71.00	6.95	8.60	12.40	13.00	20.20	23.00	41W20

**Disclaimer:**

Dimensional data and technical information was obtained from publically available sources and not acquired through standard agencies. It has been completed and compiled for reference purposes only; where discrepancies are found they are subject to change without notice. Bolt & Nut Australia makes no warranties or representations regarding the accuracy and validity of the compiled information and data. Contact the relevant standard authorities for accurate and detailed information.

© Bolt & Nut Australia Pty Ltd. All rights reserved.

Version: 17 Mar 2026