

DID YOU KNOW?

about our... **METAL SDS WAFER HEAD ZYP**



DRILLX[®]

FAST AND SECURE DRIVE INTO STEEL

METAL SDS WAFER HEAD ZYP
ZINC YELLOW PASSIVATE / AS3566 PHILLIPS DRIVE

Part	QFind	Size Ø (mm)	Length (mm)	Drive Size	Pack Qty
T9PMYWP1016022	Q390	#10-16	22	#2	1000



**NEW
PRODUCT**

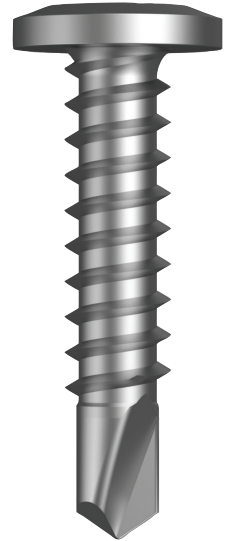

Installation:

- » Self-drilling screw - No pre-drilling required
- » Cordless or mains powered screw driver
- » #2 Phillips Drive Bit

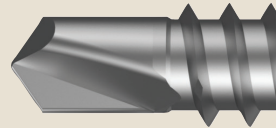

Application:

- Metal to Metal Fixing
- Electrical Fittings
- Conduit Clips
- Signage
- Steel Wall Frames
- Metal to Metal Fixing in **HVAC** Installation (Heating, Ventilation and Air-Condition)



Features:

- Low Profile Wafer Head
- Phillips Drive #2
- Flat Bearing Surface

1907071 DYK

Bolt Tension | Anti-Vibration | Product Reliability | Traceability

hobson.com.au **QUALITY FASTENERS SINCE 1935**

